

# Vision and Regeneration framework for Central Salford

Central Salford - an area of almost 2,200 hectares and home to around 72,000 people - provides possibly the largest concentration of regeneration activity in the country and certainly one of the most exciting.

A Locum-led consortium including Canadian urban design firm Urban Strategies and Italian architect Massimiliano Fuksas was appointed by Salford City Council to draw up a Vision and Regeneration Framework for the area. The resulting 20-year plan is expected to unlock hundreds of millions of pounds of private sector investment and create thousands of new jobs.

The Draft Vision and Regeneration Framework has a number of key themes which, once combined, will bring lasting and significant changes to Central Salford.

## Building on strengths

With the aim of building on Central Salford's strengths, a number of key priority areas have been identified: the Chapel Street Corridor, Salford Central Station, Pendleton, the Quays / Canal District and the Irwell Corridor.

## Green spaces and tree-lined boulevards

A network of newly paved, green, tree-lined streets will be established within Central Salford, in order to strengthen the connections and movement between communities.

## Stunning riverside developments

An interconnected river and open space system will renew the life and vibrancy of the River Irwell and will re-integrate the river system with parks and open spaces. A continuous walk along the river's edge will provide new opportunities for walking and cycling.

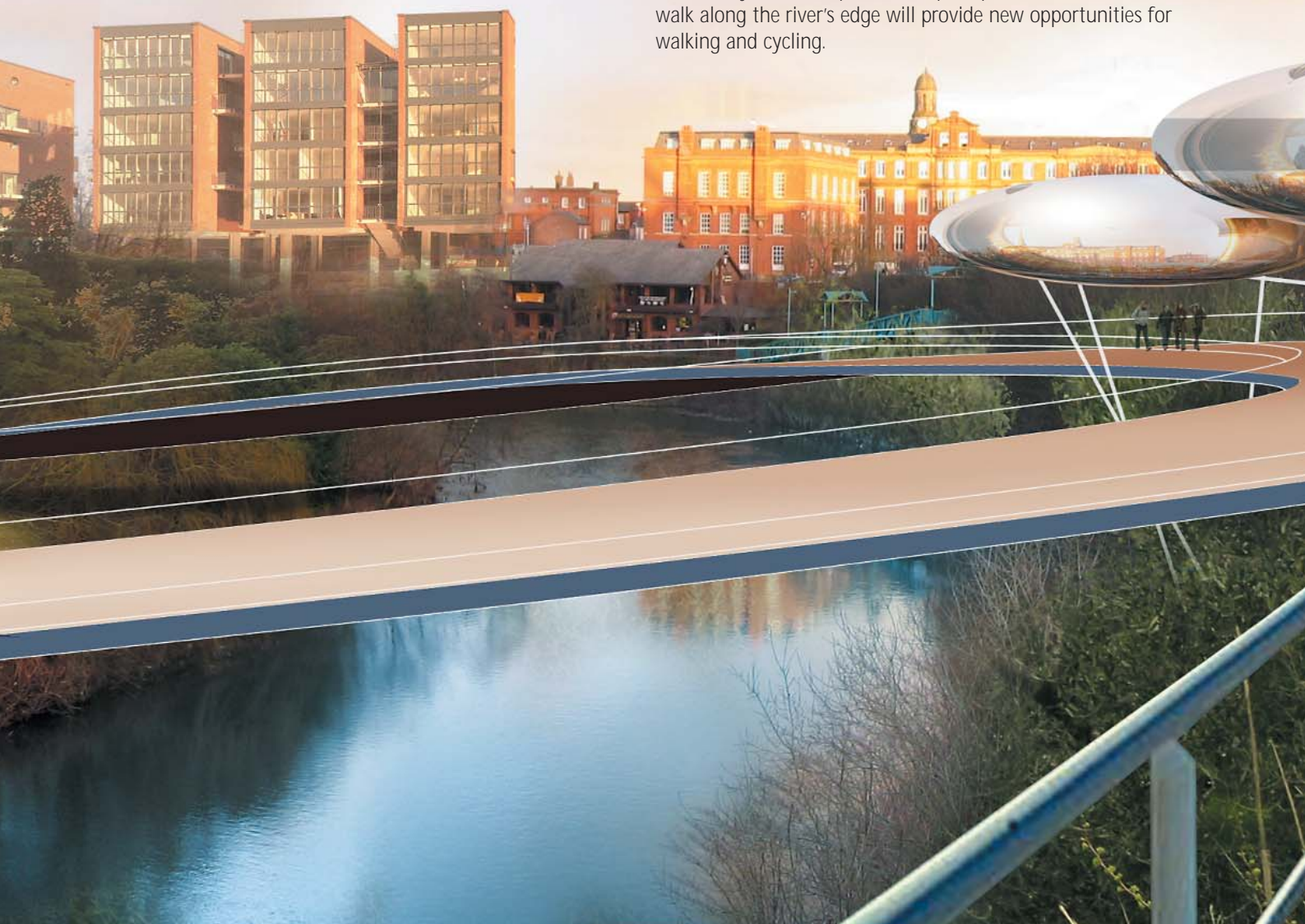

## Investing in the heart of Salford

A focus on Chapel Street will re-establish a strong and distinctive centre for Central Salford and revitalise the street quality, encouraging new commercial, leisure and retail investment. The renewal of Chapel Street will connect the economic heart of Manchester to the city of Salford.

## Connected communities

Fundamental improvements to Central Salford's transport routes will enable greater movement within the city, establishing an attractive city core and supporting the connectivity of neighbouring communities.

The aim is to make Salford a beautiful, vibrant and prosperous city where people will want to live, work and study for generations to come.

[www.salford.gov.uk](http://www.salford.gov.uk)  
[www.centralsalford.com](http://www.centralsalford.com)  
[www.chapelstreet.org.uk](http://www.chapelstreet.org.uk)  
[www.nwda.co.uk](http://www.nwda.co.uk)

